

# In from the cold

Mark Rayner shows how to build a simple wooden cold frame in a weekend.



## You will need

- 150mm treated fence palings cut to the following lengths:
  - 8 x 1200mm (front and back panels)
  - 8 x 800mm (side panels)
  - 1 x 300mm (front brace)
  - 1 x 900mm (back brace)
  - 50mm x 75mm treated timber cut to the following approximate lengths:
    - 2 x 900mm
    - 2 x 350mm
- 2 x window frames measuring 600mm x 1000mm
- 2 x 1200mm lengths of fence capping
- 40mm galvanised jolthead nails
- 25mm galvanised flat-head nails or galvanised staples
- Exterior PVA glue
- 4 x stainless steel or zinc-plated hinges with screws
- Clear plastic sheeting
- Drill
- Saw
- Screwdriver
- Hammer
- Paintbrushes
- Resene Quick Dry Waterborne acrylic primer undercoat
- Resene Lumbersider tinted to Resene Alabaster

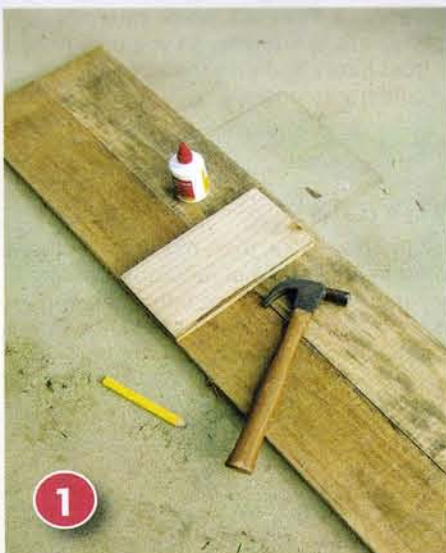

**1** Form the front panel by fixing two of the 1200mm lengths of fence paling together, attaching the front panel brace in the centre, as shown, using 40mm nails and PVA glue. Repeat with the remaining six 1200mm lengths and the back panel brace to form the back panel.



**2** Form the two side panels, as shown, using the 800mm lengths of fence paling and the lengths of 50mm x 75mm timber - note how the upper ends are cut at angles to follow the pitch of the sides. Again, fix with 40mm nails and PVA glue. Leave to dry - preferably overnight.

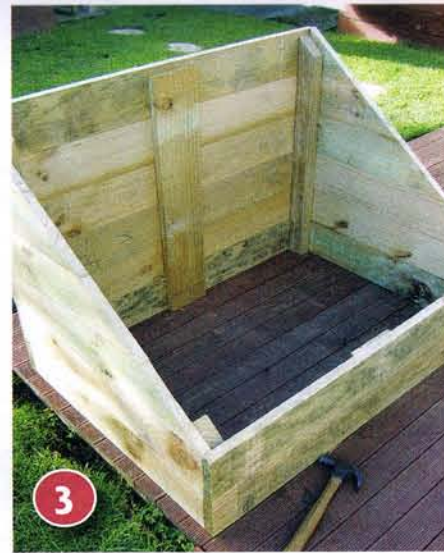

**3** Assemble the main body of the cold frame using 40mm nails and PVA glue.

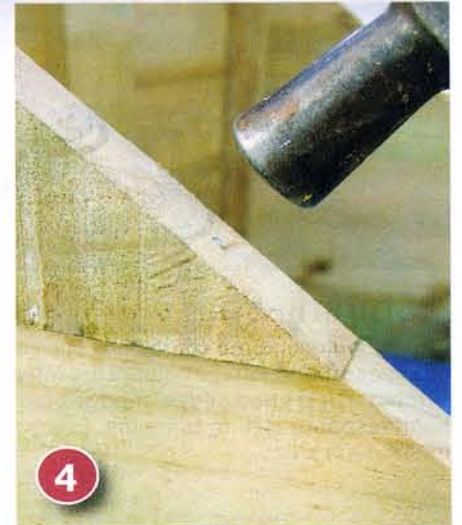

**4** Strengthen the sloping edge of the side panels by gluing and tapping a 40mm nail through at an angle, as shown - drill a pilot hole first to stop the wood splitting.

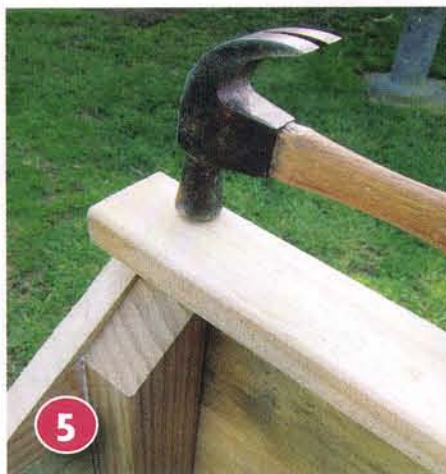

**5** Fix one 1200mm length of fence capping along the upper edge of the cold frame, using 40mm nails and PVA glue. Repeat with the second length of fence capping along the lower edge.



**6** Apply one coat of Resene Quick Dry primer undercoat to the entire cold frame and also to the window frames. Leave to dry for one hour.



**7** Apply two coats of Resene Alabaster to the entire cold frame and the window frames, allowing two hours for each coat to dry. Firmly fix the clear plastic to the underside of the window frames using 25mm nails or galvanised staples.

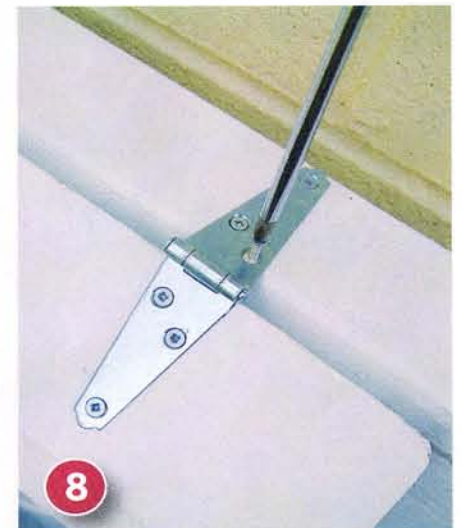

**8** Attach two hinges to the top edge of each window frame and fix to the top edge of the cold frame, using the screws provided.