

Corrugated cactus wall panel



Mark Rayner show how to turn an old shed wall into a fabulous focal point.

To get the look

Mark painted the background shed wall with Resene Lumbersider tinted to Resene Rob Roy.



1 Mix up in the bucket one part Resene Roof Wash and Paint Cleaner with three parts clean water and apply to both sides of the galvanised corrugated iron and mini corrugated iron panels. Scrub vigorously with a hand brush and rinse off with clean water. Dry with a towel or old rag.

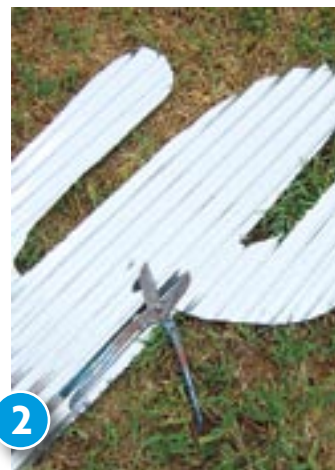

2 Using the pencil, draw cactus (about 110mm high) and a small circle (200mm diameter) on the mini corrugated iron panel. Cut these out with tin snips and smooth edges with a metal file. Apply a coat of Resene Galvo-Prime to both and the other two pieces of galvanised iron. Allow to dry for four hours.

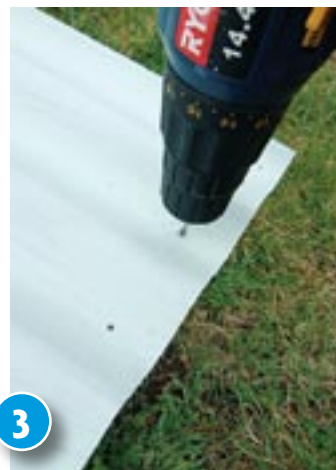

3 Attach the two lengths of 50mm x 50mm horizontally to the shed wall (approximately 1200mm apart) using 75mm stainless steel screws. Drill a series of holes along the top and bottom edges of the larger galvanised iron panel, as shown.

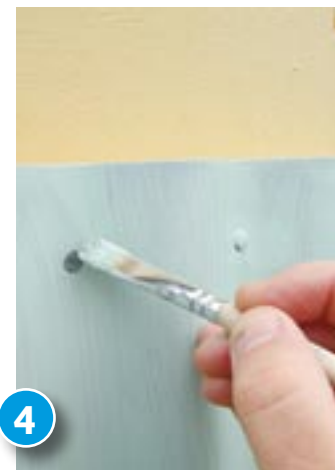

4 Attach the larger galvanised iron panel to the shed wall nailing 40mm galvanised flat-head nails through the drilled holes and into the lengths of 50mm x 50mm timber. Use a small brush to spot prime the nail heads with Resene Galvo-Prime and allow to dry for four hours.



5 Apply two coats of Resene Malibu to the galvanised iron panel, allowing two hours for each coat to dry.



6 Apply two coats of Resene Manhattan to the smaller galvanised iron panel and allow two hours to dry between coats.



7 Position the smaller panel along the bottom of the larger panel and drill a 4mm hole through both layers of iron (making sure it's where two ridges touch). Fix into position with a pop riveter (following manufacturer's instructions), and repeat until the smaller panel is firmly attached.



8 Apply two coats of Resene Green Leaf to the cactus shape and two coats of Resene Supernova to the small circle. Once dry, attach both these shapes to the corrugated iron panel, following step 7. Spot prime all rivet heads with Resene Galvo-Prime and, once dry, spot paint the rivet heads with appropriate colours.

You will need:

- Two pieces of galvanised corrugated iron cut to the following dimensions: 1300mm x 850mm (with ridges running vertically) 450mm x 850mm (with ridges running horizontally)
- 1500mm panel of galvanised mini corrugated iron
- 2 x lengths of 50mm x 50mm treated timber cut to 850mm
- Resene Roof Wash and Paint Cleaner
- Resene Galvo-Prime acrylic galvanised iron primer
- Resene Lumbersider tinted to the following colours: Resene Malibu, Resene Green Leaf, Resene Manhattan
- Testpot of Resene Supernova
- Paintbrushes
- Stiff-bristled hand brush
- Bucket/water
- Tin snips
- Pencil
- 40mm galvanised flat head nails
- 6 x 75mm stainless steel screws
- Drill with 4mm metal drill bit
- Pop riveter with rivets
- Hammer
- Metal file



For more on paints phone 0800 RESENE or visit www.resene.co.nz